

How to give EpiPen[®]

adrenaline (epinephrine) autoinjectors

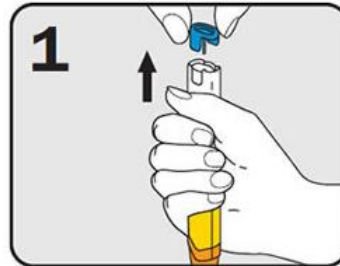

1. Form fist around EpiPen[®] and **PULL OFF BLUE SAFETY RELEASE**

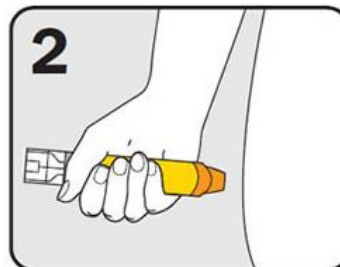

2. Hold leg still and **PLACE ORANGE END** against outer mid-thigh (with or without clothing)

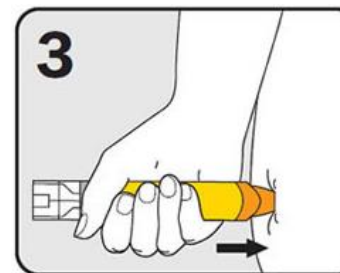

3. **PUSH DOWN HARD** until a click is heard or felt and hold for 3 seconds
REMOVE EpiPen[®]